

2023-2024

SCHOOL YEAR

FLOOD PLAN

Route Drivers

You will be notified by phone to leave for your route at least 20 minutes early to take the alternate route listed on the following pages.

Keep radio communication short by following plan.

Transfer Drivers

Last transfer driver in line at the fire station will radio route drivers to make sure that they have all been to and unloaded at the fire station.

2023-24 School Year Transportation Plan for Flooding

Route 43

If the West end of Norman Rd floods,(Near Marine Dr.) Driver will head back to Pioneer Hwy after turnaround on Miller Rd.

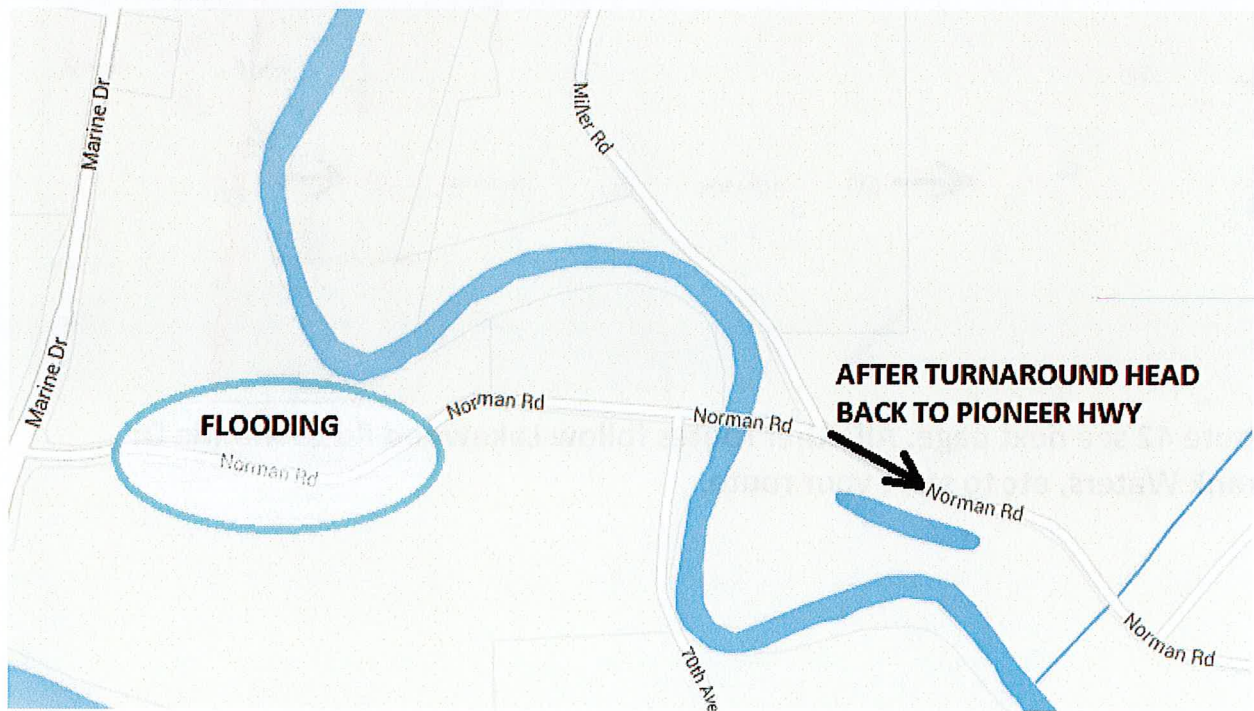

In the event of major flooding on the majority of Norman Rd. The road towards Silvana, after the bridge on Pioneer Hwy, would also be flooded. Rt 43 will use Norman Rd off of Pioneer Hwy as the turnaround and meeting place for students.

2023-24 School Year Transportation Plan for Flooding

Routes 21, 23, 24, 25 & 42

If Marine Dr. is flooded, the buses will take I-5 to the Lakewood Rd via Exit 206(Smokey Point Exit)

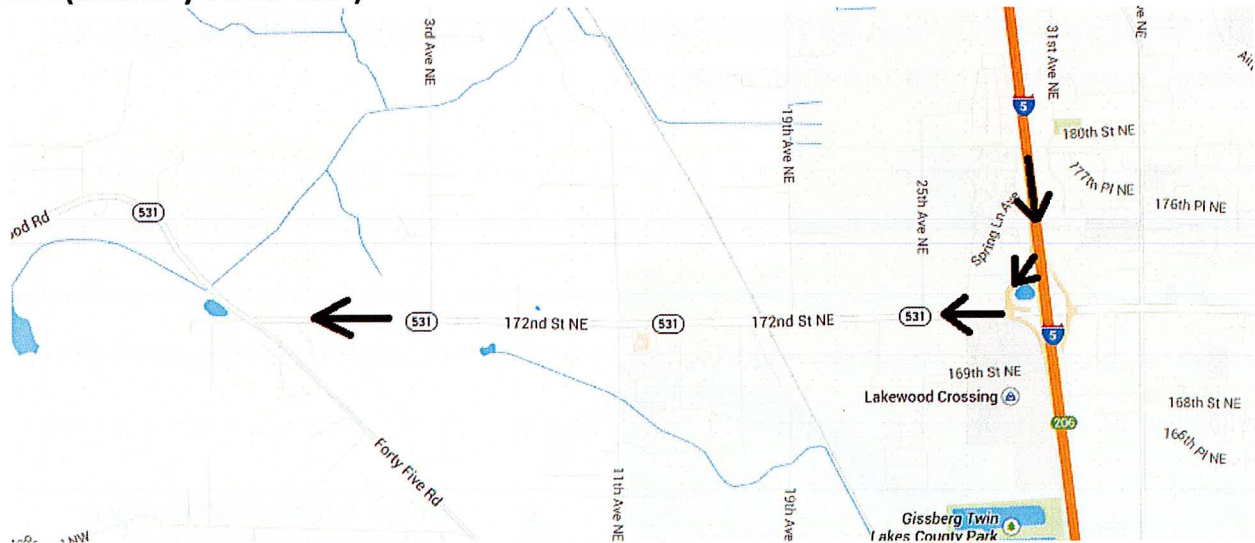

Route 42 see next page. All other routes follow Lakewood Rd to Marine Dr., Frank Waters, etc to start your route.

2023-24 School Year Transportation Plan for Flooding

Route 42 will take a right onto 40th Ave and follow the road. The road will eventually turn into Happy Valley Rd. Take a left onto Happy Hollow Rd and start route backwards from there.

ALL OTHER ROUTES SEE NEXT PAGE.

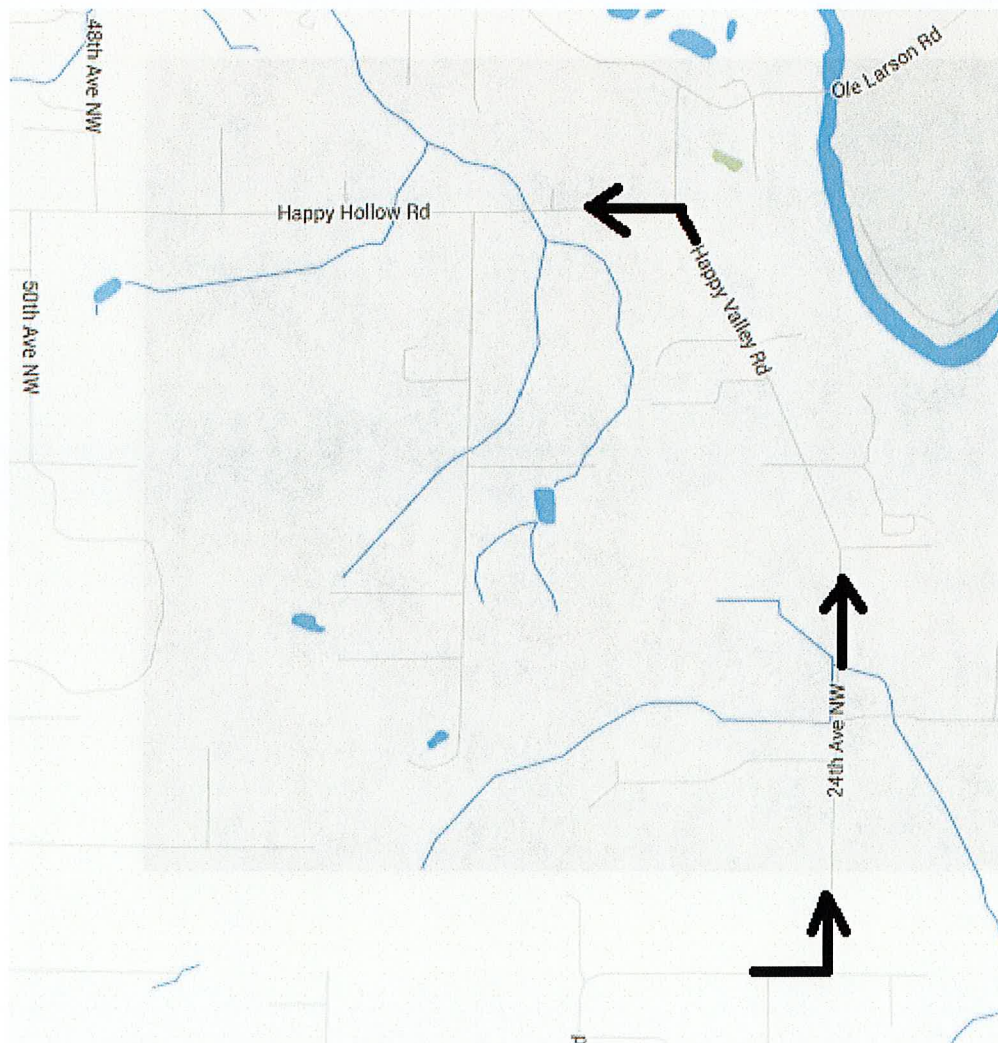

Route 42 will meet the students pickups that are on Marine Dr South of Happy Hollow at the Warm Beach Fire Station. Follow Marine Dr to Lakewood Rd. (See Instructions and map on last page.)

ALL OTHER ROUTES SEE NEXT PAGE

2023-24 School Year Transportation Plan for Flooding

Meet other buses at the fire station in Warm Beach. The address 19727 Maine Drive. (See Map) There will be a bus and a driver at the lot. The drivers walk to your bus and give you the keys to the spare. Then they will transport your HS/MS students on to school. You can begin your elementary route from the fire station parking lot.



In the afternoon if Marine Dr. is still flooded we will pick up students at SES and TCE and meet you at the swapping location again.

2023-24 School Year Transportation Plan for Flooding

Special Needs Bus Routes will drive their entire route but will need to access this area via I-5 south through Smokey Point & Lakewood. Please plan to arrive early to leave 20 minutes prior to your normal leave time. We may need help in calling your families to alert them that you will be delayed. It is a good idea to talk with your families now and let them know that if there is flooding that you will have to drive around and will be delayed.